

PS1A Acoustic Panels

2" Tongue & Groove

Performance

- > Performance based on a 2" thick panel with 18GA outer sheet and 22GA inner liner filled with Acoustic grade media

Advantages

- > Self aligning and interlocking
- > Easy to assemble at job site
- > Pressure rating up to 10" W.G.
- > Well suited for large plenums walls due to inherent strength

Applications

- > Enclosures for noisy equipment
- > Acoustically sensitive rooms and booths
- > Air handling unit casings and plenums
- > Sound testing facilities
- > Acoustic Barriers for noise by law compliance

Construction

- > Roll formed inner and outer skin
- > Maximum 16 ga galvanized or stainless steel
- > Thermal/Acoustical media sandwiched between skins
- > Stiffeners installed internally to provide strength
- > Strong panel joints

Options

- > Panels can be built to required sizes
- > Panel can be built with required materials like Galvanized, stainless, Galvanneal, pre-painted or Aluminum
- > Doors, windows, access panels and openings can be provided as required
- > Thermal break
- > Lining for acoustic media (Tedlar, Mylar and Fiberglass cloth)

Octave Band	125	250	500	1000	2000	4000
Transmission Loss	20	25	39	52	53	56
Absorption	0.3	0.7	0.9	0.99	0.9	0.8

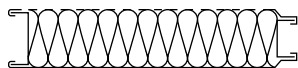
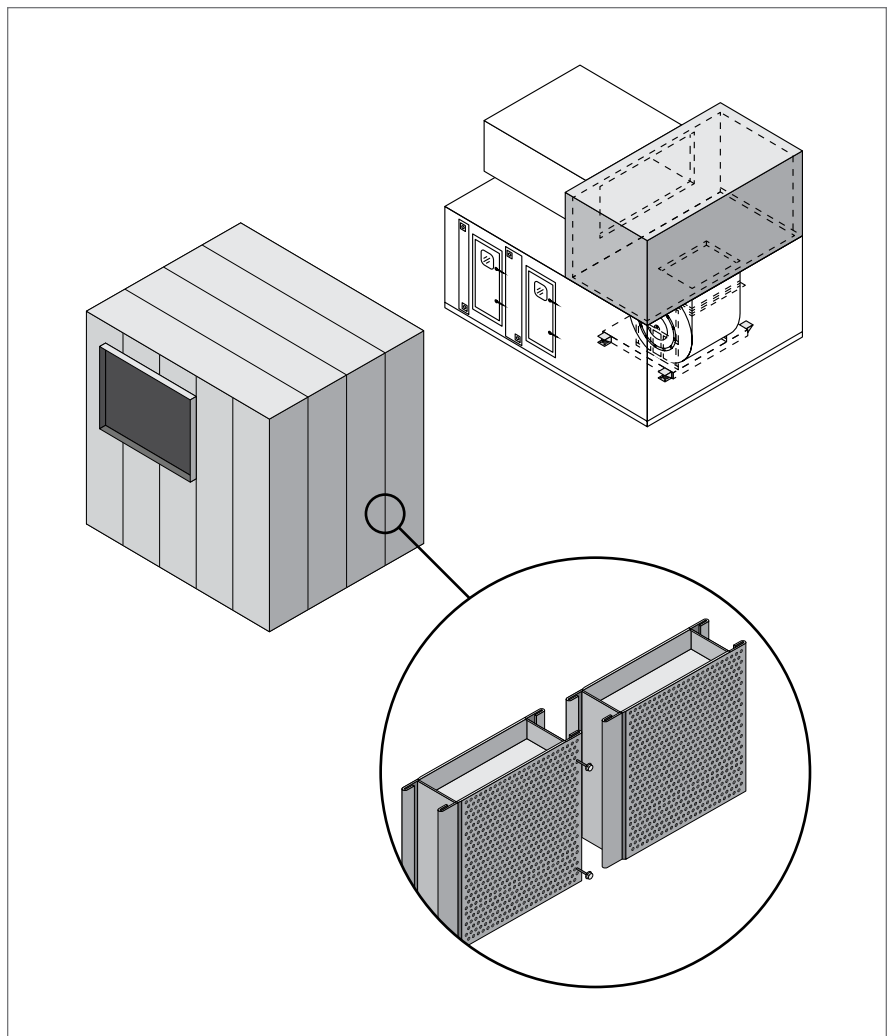

Solid / Perforated

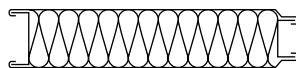

Solid / Solid

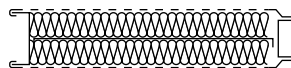

Septum

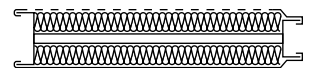

Added Mass Core